



206/14 Shoreline Drive RHODES NSW

2 2 1

Being so proud to present this stunning family home by Mirvac, located at one of the most convenient areas at Rhodes. This modern two-bedroom apartment has complete security facilities and is a very suitable living choice. You can find the fantastic lifestyle here with train station, restaurants & cafes, Ikea, waterfront leisure in walking distance.

Type : Apartment

View : <https://www.sevenrealestate.com.au/8411915>

Features:

- Large two-bedroom apartment
- Granite kitchen workbench with dishwasher and gas cooking
- Formal lounge room with combatable carpet
- Open-plan dining and living room lead directly to the

[For full version visit the website](#)

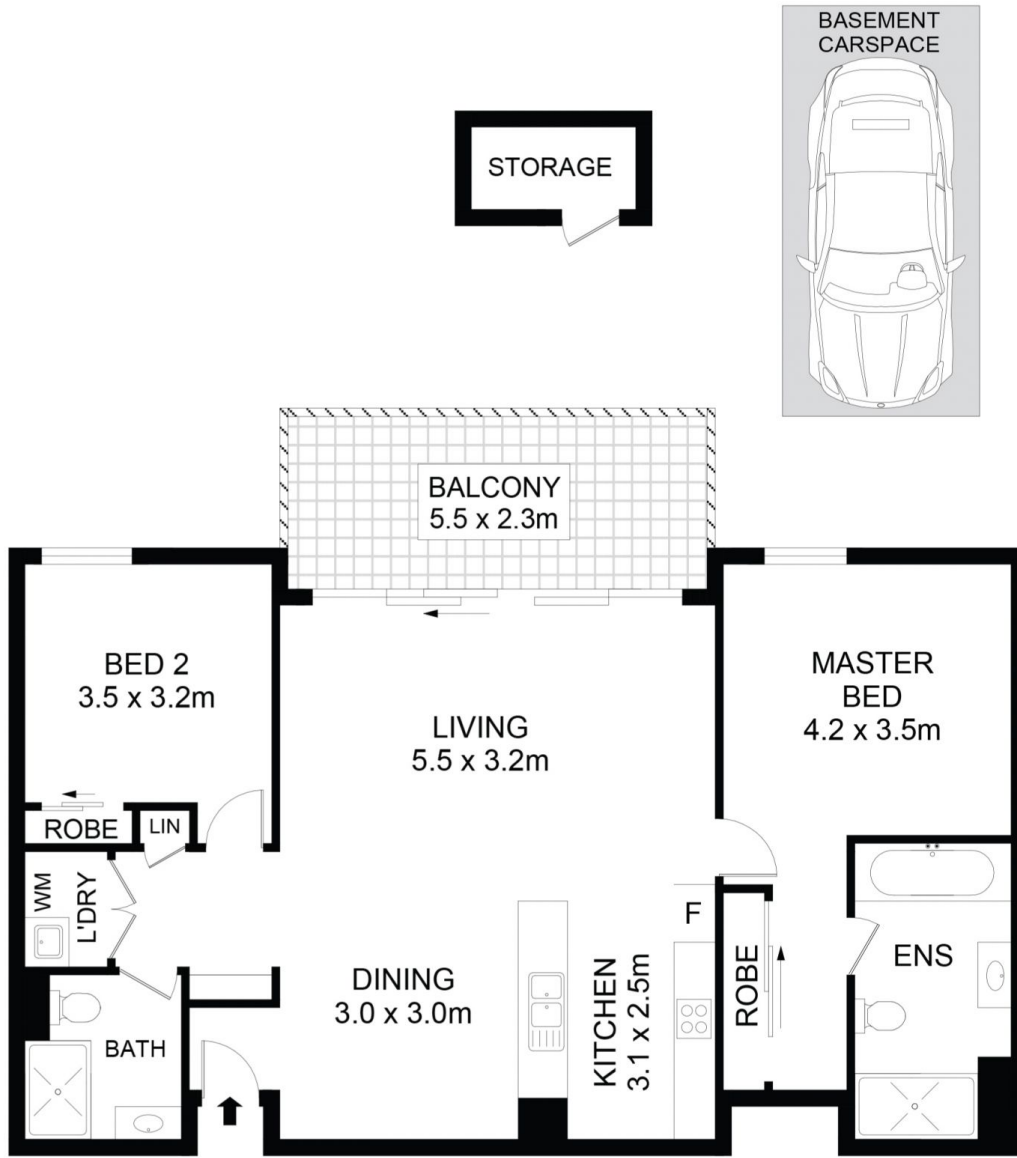

LEVEL 2

206/14 Shoreline Drive Rhodes



DISCLAIMER

DIMENSIONS ARE APPROXIMATE AND SHOULD ONLY BE USED AS A GUIDE
THEY ARE NOT TO SCALE AND NO LIABILITY WILL BE ACCEPTED